

**Plan of 1<sup>st</sup> Storey – Worship Hall (Bethel)  
 Extended Hall (Gethsemane) and Library (Emmaus)**

27 LORONGMELAYU

# 1<sup>st</sup> Storey

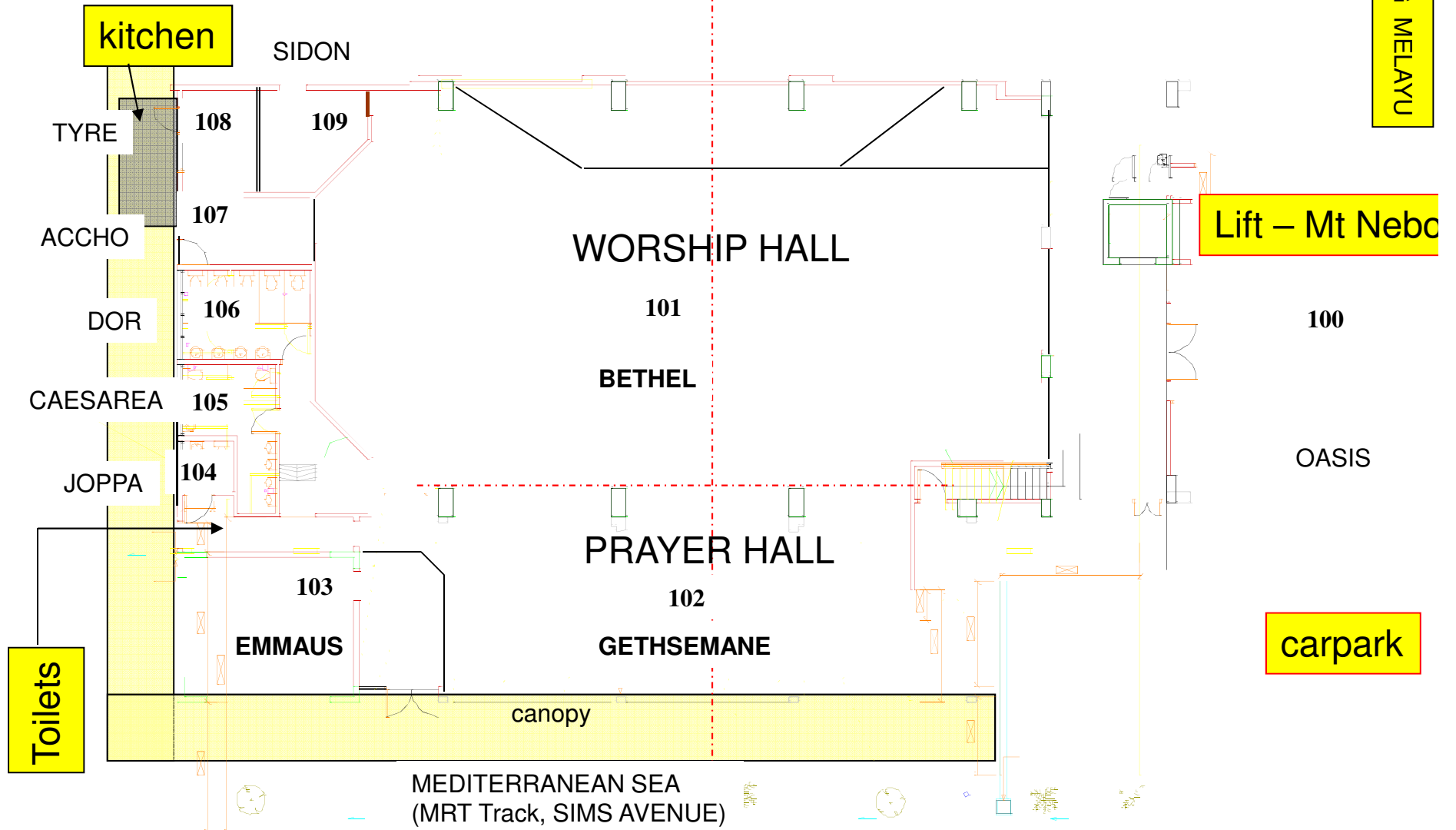

**Plan of 1<sup>st</sup> Storey – Worship Hall (Bethel)  
Extended Hall (Gethsemane) and Library (Emmaus)**

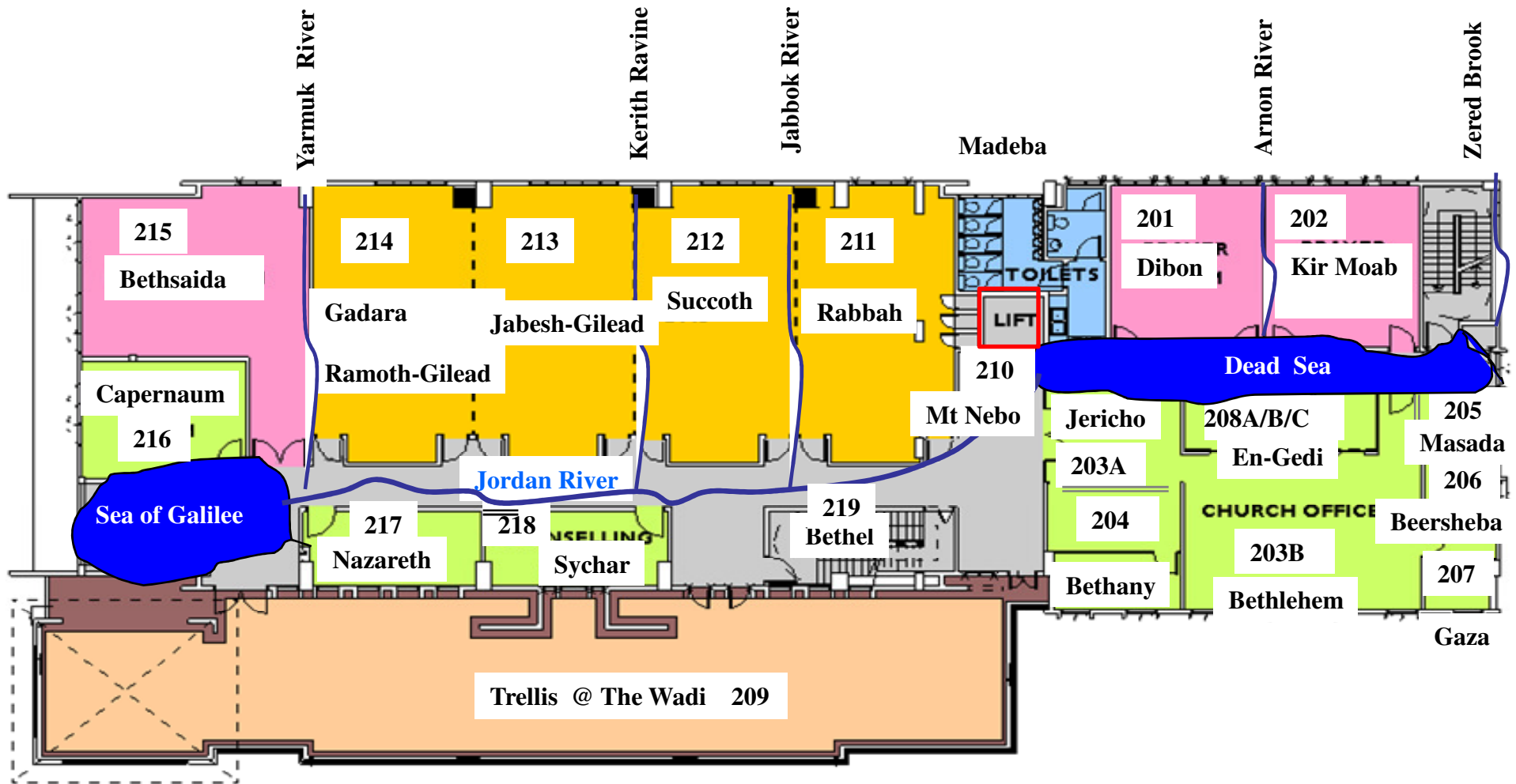

MEDITERRANEAN SEA  
(MRT Track, SIMS AVENUE)

**Plan of 2<sup>nd</sup> Storey (based on map of Israel)**

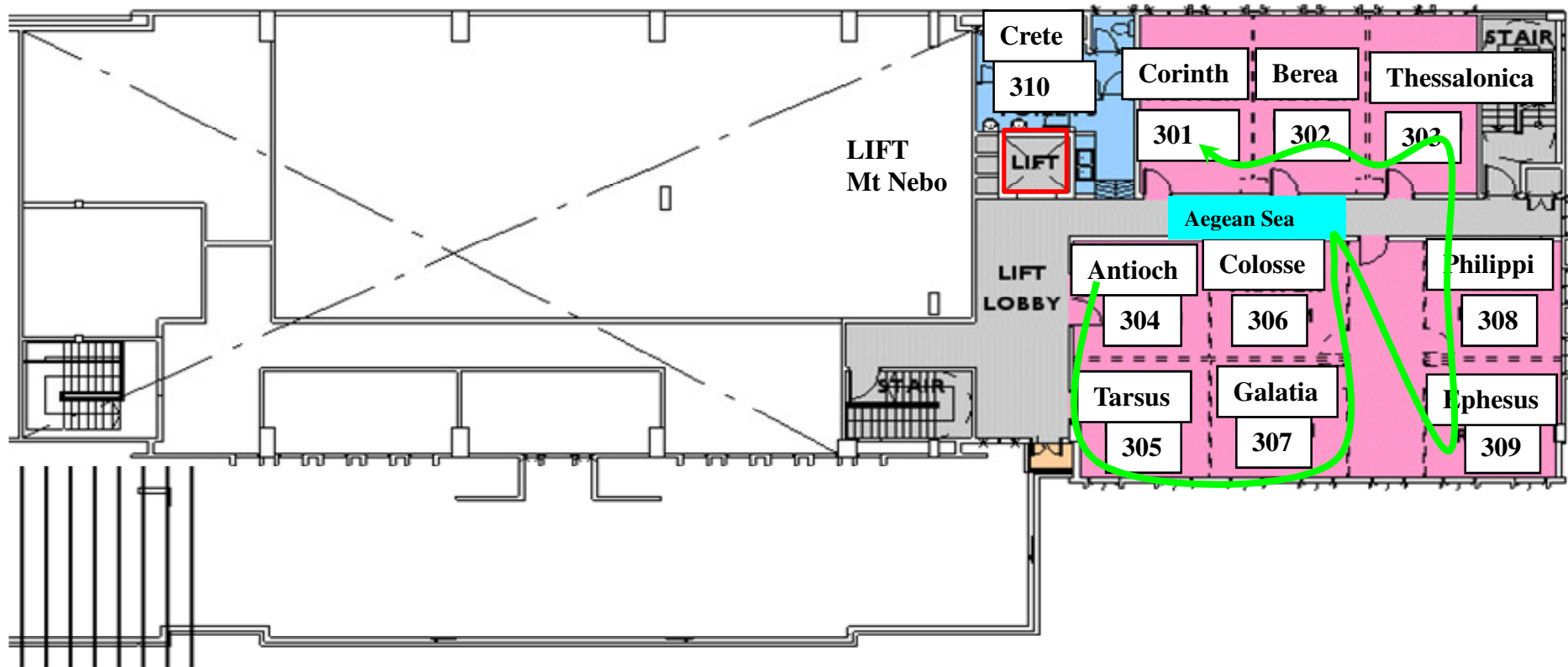

MEDITERRANEAN SEA  
(MRT Track, SIMS AVENUE)

**Plan of 3<sup>rd</sup> Storey (based on Paul's 3<sup>rd</sup> missionary journey)**

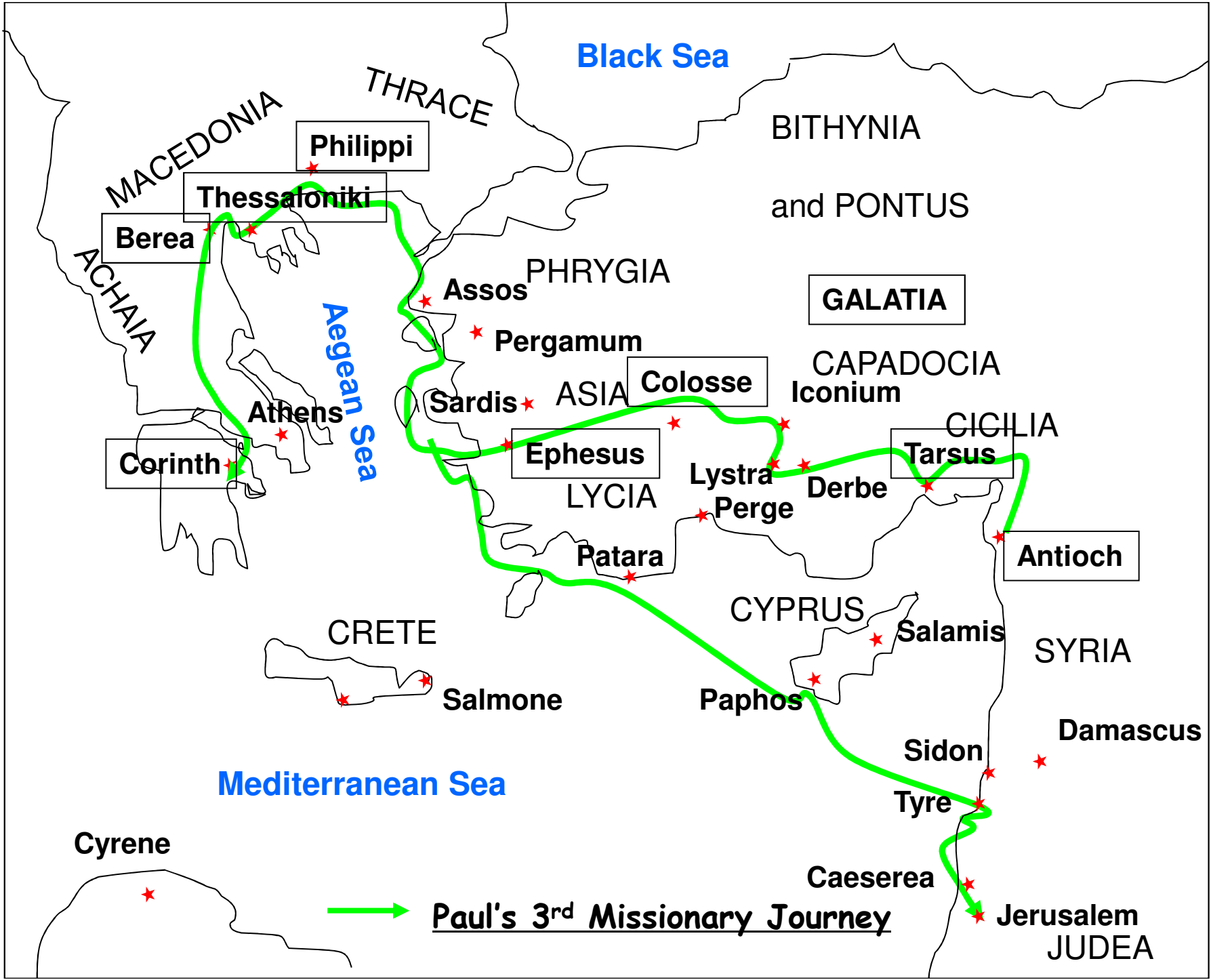

Black Sea

MACEDONIA

THRACE

BITHYNIA  
and PONTUS

Philippi

Thessaloniki

Berea

PHRYGIA

GALATIA

Aegean Sea

Assos

Pergamum

CAPADOCIA  
Iconium

ACHAIA

Athens

Sardis

ASIA

Colosse

LYCIA

Ephesus

Derbe

CICILIA

Corinth

Lystra  
Perge

Tarsus

LYCIA

Patara

Antioch

CRETE

Salmone

CYPRUS

Salamis

SYRIA

Mediterranean Sea

Paphos

Damascus

Cyrene

Sidon

Tyre

Caesarea



Paul's 3rd Missionary Journey

Jerusalem  
JUDEA

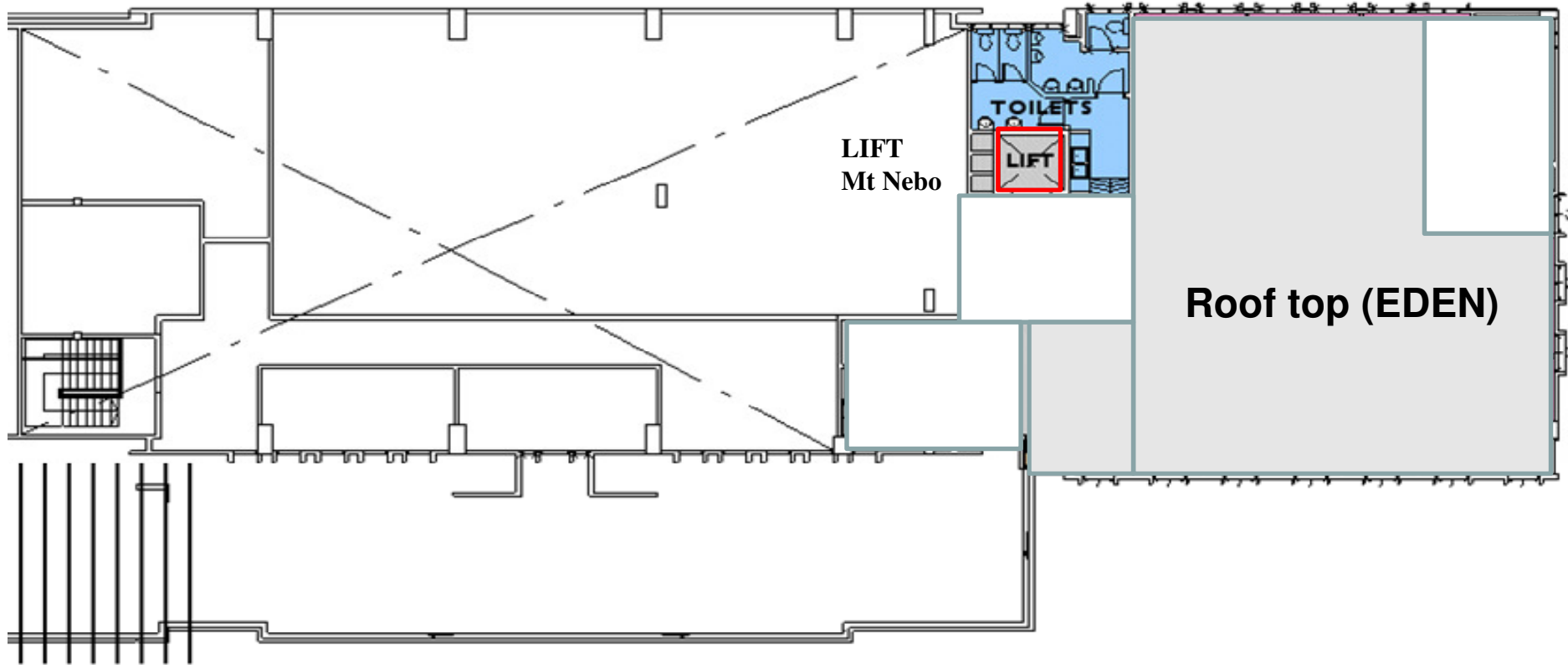

MEDITERRANEAN SEA  
(MRT Track, SIMS AVENUE)

## Plan of roof top